



FLYNN ROAD BUSINESS PARK

4030-4040 ADOLFO RD | 1267-1283 FLYNN RD

:: CAMARILLO, CALIFORNIA

INDUSTRIAL UNITS FOR LEASE

INDUSTRIAL/FLEX CONDOMINIUMS

Individual Unit Sizes:
7,957 SF; 9,910 SF

FOR INFORMATION PLEASE CONTACT

Paul Farry

Lic. 00941298
805.465.1615
paul.farry@cbre.com

Jim Meaney

Lic. 01360121
805.465.1621
jim.meaney@cbre.com

Doug Shaw

Lic. 00857630
805.465.1627
doug.shaw@cbre.com

Corey Baggett

Lic. 01835116
805.465.1651
corey.baggett@cbre.com

CB Richard Ellis, Inc.

Broker Lic. 00409987
771 E. Daily Drive
Suite 300
Camarillo, CA 93010
T 805.465.1600
F 805.465.1665

www.cbre.com/ventura



Located at the corner of Flynn and Adolfo Roads, Flynn Road Business Park offers an "A" location with easy access to 101 Freeway via Flynn Road, Santa Rosa Road or Lewis Road.

FEATURES

- Part of a Master Planned business center on approx. 13 acres
- Final phase of TOLD Corporation's Flynn Road Business Park
- Turn key units featuring maximum office build-out, upstairs and downstairs rest rooms, coffee bar on both floors and office finishes usually found only in high-end corporate offices
- Protective CC&Rs enhance value now and in the future
- High bay warehouse / 23' clear - 480V Power
- **LOCATION - LOCATION - LOCATION**



LOCATION

- Immediate access to the Ventura Freeway (US 101)
- Minutes from the Conejo Valley
- Traffic counts at retail level

© 2010 CB Richard Ellis, Inc. This information has been obtained from sources believed reliable. We have not verified it and make no guarantee, warranty or representation about it. Any projections, opinions, assumptions or estimates used are for example only and do not represent the current or future performance of the property. You and your advisors should conduct a careful, independent investigation of the property to determine to your satisfaction the suitability of the property for your needs.

FLYNN ROAD BUSINESS PARK

4030-4040 ADOLFO RD | 1267-1283 FLYNN RD

:: CAMARILLO, CALIFORNIA

INDUSTRIAL UNITS FOR LEASE

INDUSTRIAL/FLEX CONDOMINIUMS

Individual Unit Sizes:
7,957 SF; 9,910 SF

FOR INFORMATION
PLEASE CONTACT

Paul Farry
Lic. 00941298
805.465.1615
paul.farry@cbre.com

Jim Meaney
Lic. 01360121
805.465.1621
jim.meaney@cbre.com

Doug Shaw
Lic. 00857630
805.465.1627
doug.shaw@cbre.com

Corey Baggett
Lic. 01835116
805.465.1651
corey.baggett@cbre.com

CB Richard Ellis, Inc.
Broker Lic. 00409987
771 E. Daily Drive
Suite 300
Camarillo, CA 93010
T 805.465.1600
F 805.465.1665

www.cbre.com/ventura

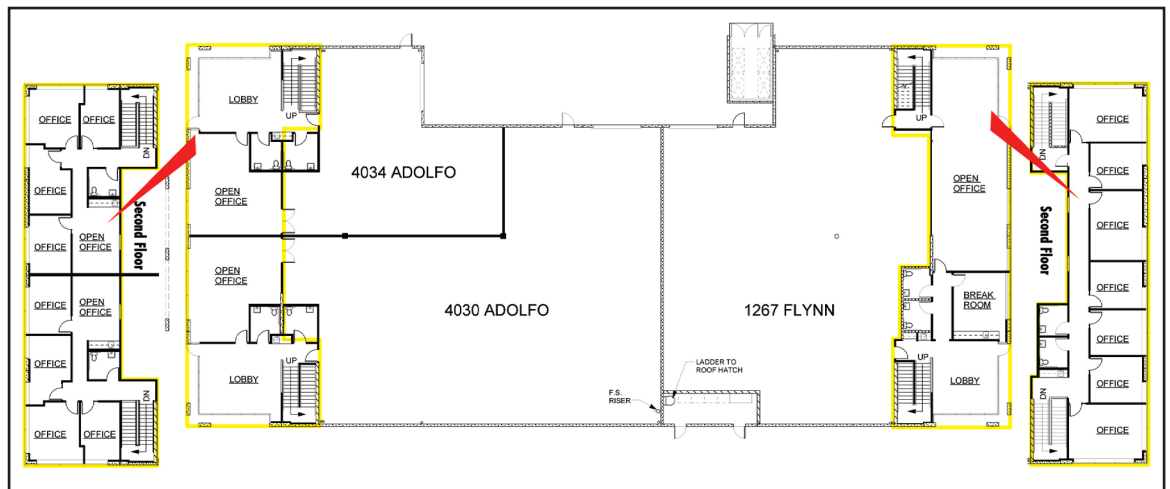

SPECIFICATIONS

Power A 600*, V 277-480
Ø 3, W 4 *(A 400
4034-36 Flynn Rd.)

Doors One 12' x 14' G.L.

Clear Height 23'

Zoned M1

Year Built 2008

	1267 Flynn Rd.	4030 Adolfo Rd.	4040 Adolfo Rd.
Whse/Mfg	5,690 SF	5,557 SF	5,557 SF
Ground Floor Office	2,110 SF	1,200 SF	1,200 SF
Mezzanine Office	2,110 SF	1,200 SF	1,200 SF
Total Office	4,220 SF	2,400 SF	2,400 SF
Total SF	9,910 SF (43%)	7,957 SF (30%)	7,957 SF (30%)
Lease Rate	\$0.87/SF Gross	\$0.85/SF Gross	\$0.85/SF Gross

© 2010 CB Richard Ellis, Inc. This information has been obtained from sources believed reliable. We have not verified it and make no guarantee, warranty or representation about it. Any projections, opinions, assumptions or estimates used are for example only and do not represent the current or future performance of the property. You and your advisors should conduct a careful, independent investigation of the property to determine to your satisfaction the suitability of the property for your needs.